

Dismantling and rinsing the dual spout

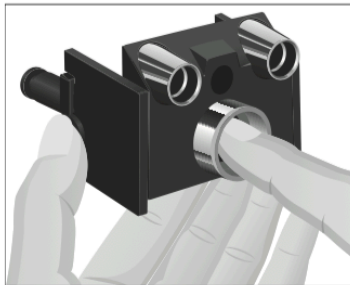
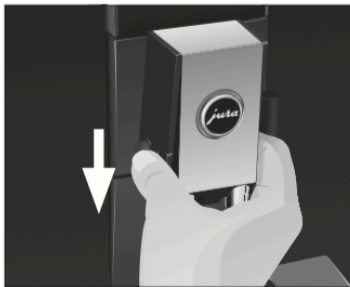
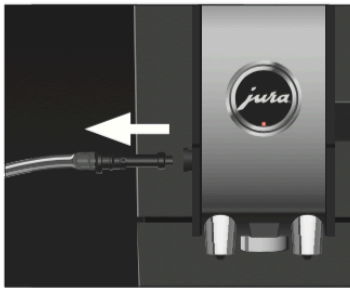

The dual spout must be dismantled and rinsed **daily** if milk has been prepared to make sure it functions perfectly and also in the interests of hygiene.

- ▶ Remove the milk pipe and rinse it thoroughly under running water.

- ▶ Press the releasing devices and pull the dual spout down and off.

- ▶ Press the milk system down and take it out.

- ▶ Dismantle the milk system into its individual parts.
- ▶ Rinse all the parts under running water. If there are severely dried-on milk residues, firstly immerse the individual parts in a solution of 250 ml cold water and 1 capful of JURA milk system cleaner. Then rinse the parts thoroughly.

- ▶ Fit the air intake pipe.

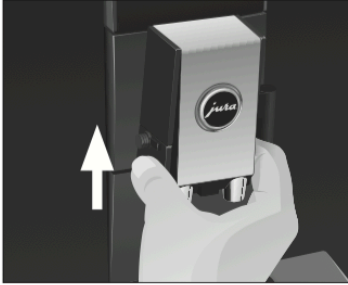
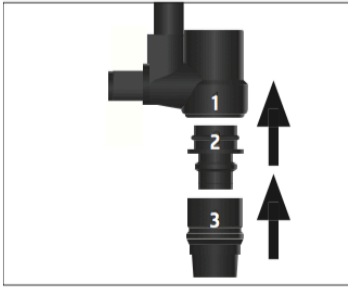

- ▶ Reassemble the milk system. When doing this, note the numbering of the individual parts.
- ▶ Fit the assembled individual parts back in the dual spout and press it firmly.
- ▶ Fit the dual spout on the machine. It will click into place audibly.